

Product Datasheet

MiniLED150

The MiniLED150 is a compact and efficient white light LED fibre optic light source.

Using the Starscape Infinity system, the MiniLED150 has a capacity of 600 mixed diameter star points.

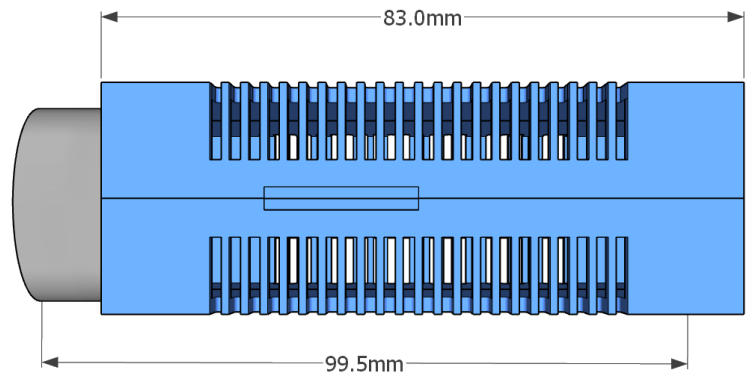
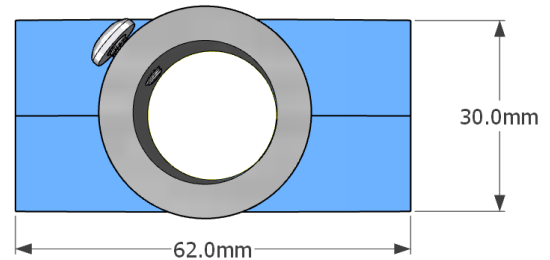

Optical port size (ID)	20mm
Supported fibre types	PMMA / Glass
Supply voltage	240ac via transformer 3 pin plug
PSU output	12v DC
Power consumption	4 watts
LED (power & colour temperature)	3w (Cool white)
Operating temperature range	-10°C / +40°C
Operating environment	Dry, ventilated.
Control options	N/A
Effects range	White light
Dimensions	99.5 x 62 x 30mm
Weight	117gr
LED Lifespan	50,000 hours (nominal)
Material & colour	Plastic – blue, Aluminium - silver
Country of manufacture	China (ISO9001 accredited)